



Single & Double-Ended Cordsets

Single Keyway M12

#18 AWG yellow PUR high-flex cable - DC color code
 Oil- and abrasion-resistant polyurethane jacket
 Highly reliable low-resistance contact design with gold/palladium nickel plating

	3P	4P
FEMALE FACE VIEW		
COLOR CODE	1- brown 2- not used 3- blue 4- black 5- not used	1- brown 2- white 3- blue 4- black 5- not used
VOLTAGE	250V AC/DC	250V AC/DC
CURRENT	4A	4A
CONDUCTOR	#18-3	#18-4

FEMALE	FIG	SINGLE-ENDED CORDSETS WITH #18 AWG HIGH FLEX PUR CABLE 2 METERS LONG	
STRAIGHT	1	803000B02M020	804000B02M020
90°	2	803001B02M020	804001B02M020
MATING RECEPTACLE*	5	8R3006A16A120	8R4006A16A120
MALE	FIG	SINGLE-ENDED CORDSETS WITH #18 AWG HIGH FLEX PUR CABLE 2 METERS LONG	
STRAIGHT	3	803006B02M020	804006B02M020
MATING RECEPTACLE*	7	8R3A00A16A120	8R4A00A16A120
FEMALE/MALE	FIG	DOUBLE-ENDED CORDSETS WITH #18 AWG HIGH FLEX PUR CABLE 2 METERS LONG	
STRAIGHT/STRAIGHT	4	883030B02M020	884030B02M020
90°/STRAIGHT	6	883031B02M020	884031B02M020

CATALOG OPTIONS

*See Page 116 for additional Mating Receptacles

Use the following chart to modify your part's specifications

803000B02M0201

CABLE LENGTH

4 METER	040
5 METER	050

COUPLING NUT

STAINLESS STEEL	...ADD 1
-----------------	----------

Specifications

CONNECTOR DIMENSIONS

FEMALE STRAIGHT

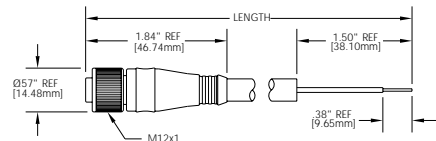

FIG 1

FEMALE 90°

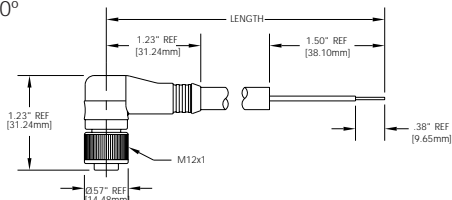
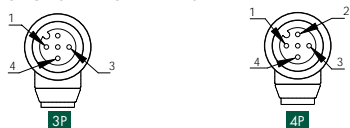

FIG 2

FEMALE CONNECTORS - FACE VIEWS



MALE STRAIGHT

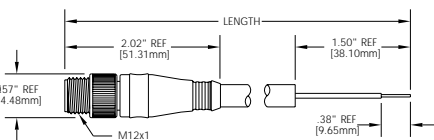

FIG 3

FEMALE STRAIGHT/MALE STRAIGHT

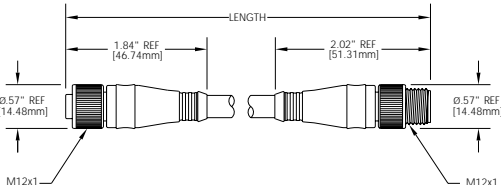

FIG 4

FEMALE 90° /MALE STRAIGHT

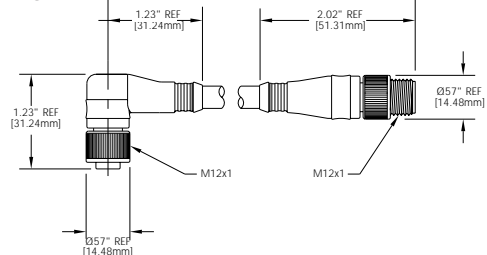
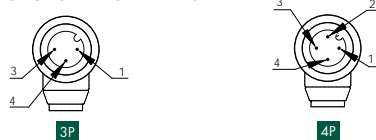

FIG 6

MALE CONNECTORS - FACE VIEWS



- MECHANICAL**
 CONNECTOR FACE: NYLON 6/6
 MOLDED BODY: POLYURETHANE
 O-RING: VITON
 COUPLING NUT: ZINC DIECAST W/ BLACK EPOXY COAT, OPTIONAL STAINLESS STEEL TYPE 303
- CABLE:** YELLOW #18 AWG POLYURETHANE JACKET AND PVC CONDUCTOR INSULATION OVER 65 X #36 COPPER STRANDING, 300V, UL STYLE 20549, CSA AWM I/II A/B
- OUTSIDE DIAMETER:**
 3P - .27" (6.9mm)
 4P - .29" (7.4mm)
- ELECTRICAL**
 VOLTAGE RATING: 250V AC/DC
 AMPERAGE: 3P - 4A
 4P - 4A
- ENVIRONMENTAL**
 PROTECTION: IP 68, NEMA 6P
 AMBIENT OPERATING TEMP: -4° TO 176° F (-20° TO 80° C)
- CERTIFICATIONS**
 UL: UL LISTED, FILE NO. E152210
 CSA: CSA CERTIFIED, FILE NO LR6837

RECEPTACLE DIMENSIONS

MALE RECEPTACLE W/ EXTERNAL THREADS AND 1/2" -14NPT THREADS

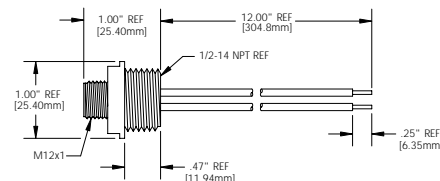

FACE VIEW

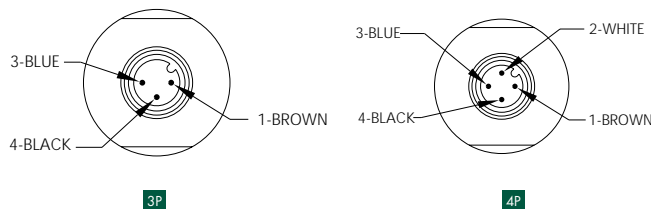

SEE PAGE 116 FOR ADDITIONAL RECEPTACLES

FIG 5

FEMALE RECEPTACLE W/ INTERNAL THREADS AND 1/4" -18NPT THREADS

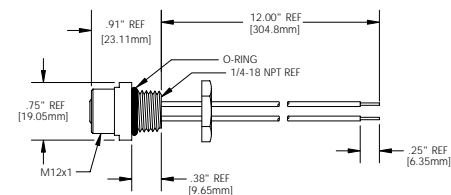

FIG 7